

# INSTALLATION GUIDE - NF7850 CONNECTOR

Connector Parts	
1.	Main Body
2.	Back Nut Collet
3.	Back Nut
4.	O-Ring
5.	Heatshrink

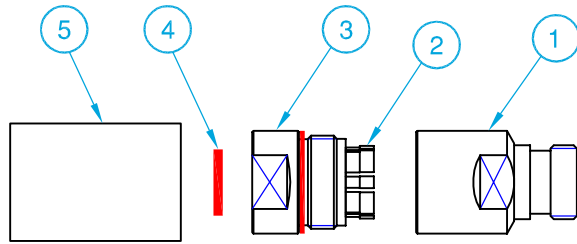

1. Strip outer jacket of Cable to 22mm. Outer jacket is cut at the apex of the corrugated Outer Conductor

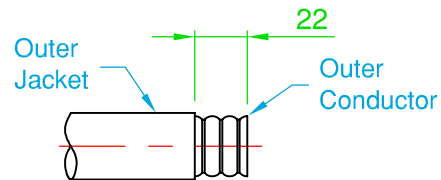

2. Install O-Ring into the Outer Conductor valley closest to the outer jacket. Use a little O-Ring Grease.

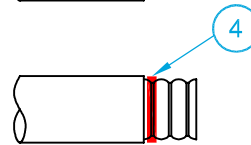

3. Install Back Nut of Connector onto Cable. There should be two audible clicks as the fingers of the internal Collet slip into the valleys of the Outer Conductor.

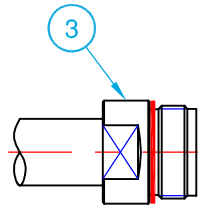

**NOTE:** The Nut is very hard to remove once it is on the Cable; ensure everything is right before installing Back Nut!

4. Flare-out the edge of the Outer Conductor to an approx. diameter of the Collet; - use a Screw Driver - do not flare-out beyond the Collet as may cause a short.

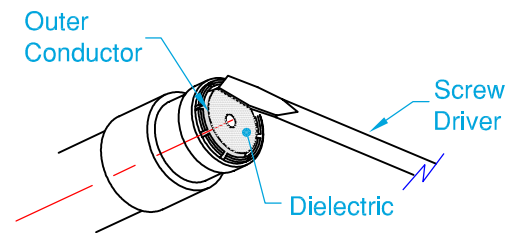

5. Before installing Main Body, check that the Outer Conductor is seating well and that there is no copper swarf remaining within the Connector.

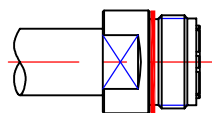

6. Install Main Body - hold Back Nut stationary and turn the Main Body to fasten

Hold the Back Nut & turn the Main Body to fasten

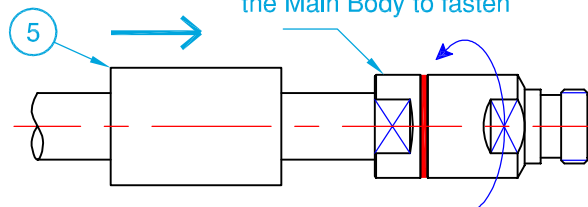

7. Install Heatshrink

